

FRONT VIEW

LHS VIEW (SIDE COVER REMOVED)

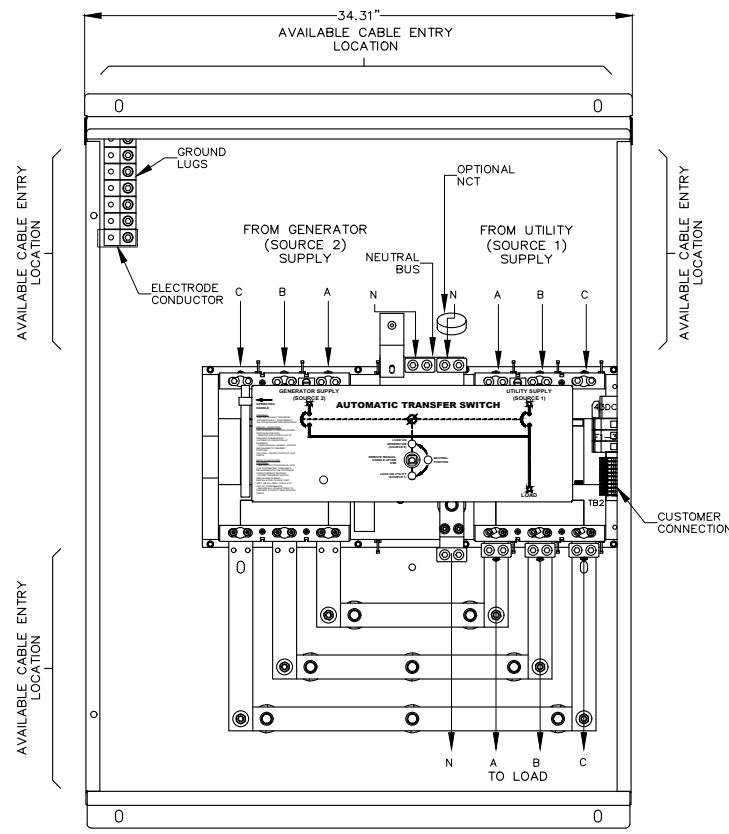

INTERIOR FRONT VIEW (DOOR NOT SHOWN)

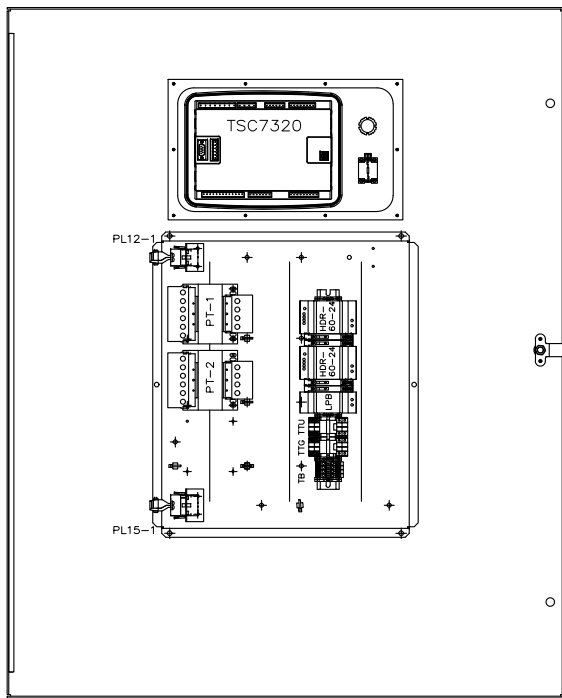

VIEWED FROM REAR (INSIDE) OF DOOR

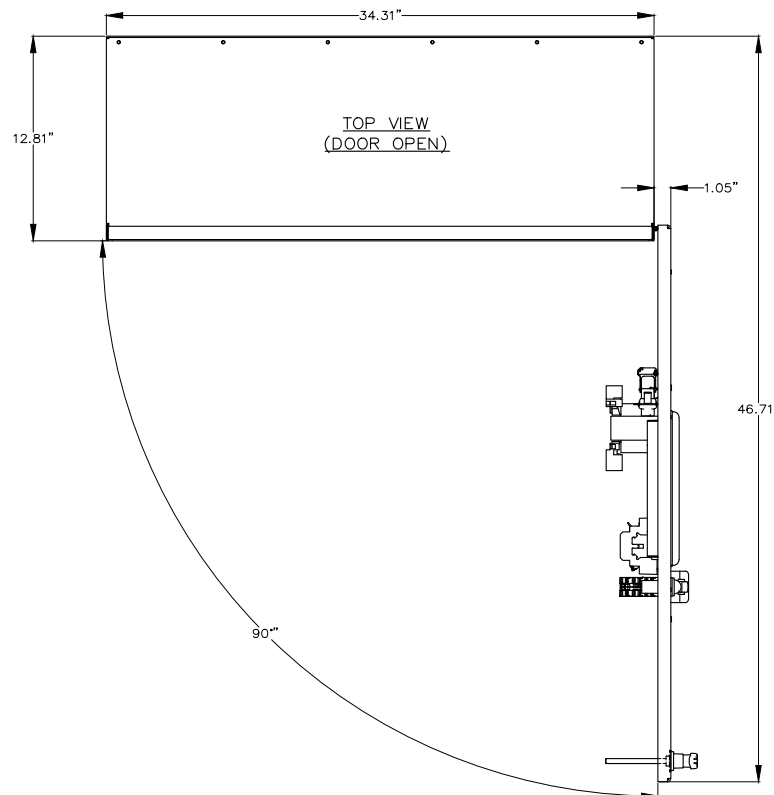

TOP VIEW (DOOR OPEN)

SERVICE ENTRANCE ATS - USD					
CLOSING AND INTERRUPTING RATING AVAILABLE AMPS (RMS)					
CLOSING & INTERRUPTING RATINGS SHOWN ARE ONLY FOR ATS UTILITY AND/OR GENERATOR POWER SWITCHING DEVICE(S) THAT ARE FACTORY SUPPLIED WITH INTEGRAL OVERCURRENT PROTECTION. PLEASE REFER TO PRODUCT INSTRUCTION MANUAL FOR FURTHER INFORMATION ON UPSTREAM PROTECTION REQUIREMENT.					
BASIC MODEL TS87xA	MAX. VOLTAGE	RATED CURRENT (A)	NO UPSTREAM OVERCURRENT PROTECTION REQUIRED		
			②40V	④480V	⑥600V
TS 87xA-400	600	400	65,000	50,000	25,000

STANDARD ATS - GSD					
CLOSING AND WITHSTAND RATING AVAILABLE AMPS (RMS)					
CLOSING & WITHSTAND RATINGS SHOWN ARE ONLY FOR ATS UTILITY AND/OR GENERATOR POWER SWITCHING DEVICE(S) THAT ARE NOT FACTORY SUPPLIED WITH INTEGRAL OVERCURRENT PROTECTION. PLEASE REFER TO PRODUCT INSTRUCTION MANUAL FOR FURTHER INFORMATION ON UPSTREAM PROTECTION REQUIREMENT.					
BASIC MODEL TS87xA	MAX. VOLTAGE	RATED CURRENT (A)	NO UPSTREAM OVERCURRENT PROTECTION REQUIRED		
			②40V	④480V	⑥600V
TS 87xA-400	600	400	65,000	50,000	35,000

CONNECTION DATA		
400A ATS	UTILITY (SRC1)	1-2C, 2/0-500MCM Cu/Al PER PHASE
	GENERATOR (SRC2)	1-2C, 2/0-500MCM Cu/Al PER PHASE
	LOAD	1-2C, 2/0-500MCM Cu/Al PER PHASE
	NEUTRAL	1-2C, 2/0-500MCM Cu/Al PER SOURCE
	GROUND	6C, #6-250MCM Cu/Al

- GENERAL NOTES**
- POWER SWITCHING DEVICES ARE MECHANICALLY INTERLOCKED SO THAT ONLY ONE DEVICE IS CLOSED AT A TIME
  - NEMA 12 / NEMA 3R SD ENCLOSURE C/W GASKETING
  - FOR 1 PHASE, 3 WIRE SOLID NEUTRAL APPLICATION, CONNECT PHASE TO 'A' & 'B'. OMIT 'C'
  - FOR 1 PHASE, 3 WIRE SWITCHED NEUTRAL APPLICATION, CONNECT PHASE TO 'A' & 'B'. CONNECT NEUTRAL TO 'C'
  - REFER COVER PAGE / SELECTED OPTION LIST FOR PROJECT SPECIFIC DETAILS

**2.5" x 5"**

**⚠ DANGER PELIGRO**

**Arc Flash and Shock Hazard**  
Will cause severe injury or death. More than one live circuit - see diagram. Disconnect all sources of supply before servicing. This equipment must be installed and serviced only by qualified electrical personnel utilizing safe work practices and appropriate Personal Protective Equipment (PPE). Failure to comply may result in injury or death! Refer to NFPA 70E for minimum PPE requirements.

**Risque d'Arc Electrique et d'Electrocution**  
Peut causer des blessures graves ou la mort. Plus d'un circuit sous tension - voir schéma. Couper toutes les sources d'alimentation avant de faire l'entretien et les réparations. Ce matériel doit être installé et entretenu uniquement par un électricien qualifié. Ce dernier doit connaître les pratiques de travail sécuritaires et porter l'équipement de protection individuelle approprié. Le non respect peut entraîner des blessures ou la mort! Reportez-vous à NFPA 70E pour le manuel des exigences minimales PPE.

**Riesgo de Arco y Choque Eléctrico**  
Se causarán lesiones graves o muerte. Más de un circuito energizado - ver diagrama. Desconectar todas las fuentes de suministro antes de hacer mantenimiento. Este equipo solo se debe instalar y mantener por personal calificado, usando medidas de seguridad y equipo de protección personal adecuados. No seguir estas recomendaciones puede causar lesiones o muerte! Consulte la NFPA 70E para los requisitos mínimos del equipo de protección personal (PPE).

QTY = 1

FOIL LABEL  
BLACK LETTERS ON SILVER BACKGROUND

**WARNING**  
TO ENSURE SAFETY OF PERSONNEL DOOR MUST BE LOCKED CLOSED WHEN USING THE "SERVICE DISCONNECT" SWITCH TO ISOLATE LOAD CIRCUITS. FASTEN DOOR SECURELY WITH SCREWS BEFORE LOCKING.

QTY = 1

0.75" x 2" (TYPICAL)  
WHITE LETTERS ON BLACK BACKGROUND

SDL  
SERVICE DISCONNECTED

QTY = 1

43SD  
SERVICE DISCONNECT TRANSFER ENERGIZED TO NEUTRAL DISCONNECTED

QTY = 1

FOIL LABEL  
BLACK LETTERS ON SILVER BACKGROUND

**SERVICE DISCONNECT INSTRUCTIONS**  
TO DISCONNECT UTILITY AND GENERATOR SUPPLIES:

- MOVE SERVICE DISCONNECT SWITCH TO "THE TRANSFER TO NEUTRAL" POSITION. WAIT 2 SECONDS TO ALLOW ATS TO MOVE TO NEUTRAL POSITION.
- MOVE SERVICE DISCONNECT SWITCH TO DISCONNECTED POSITION
- LOCK OFF SERVICE DISCONNECT SWITCH WITH SUITABLE PADLOCK.
- VERIFY LOAD IS DISCONNECTED VIA ILLUMINATED SERVICE DISCONNECT LIGHT. IF LIGHT IS NOT ILLUMINATED REFER TO INSTRUCTION MANUAL.
- LOCK ENCLOSURE DOOR CLOSED AND REMOVE KEY.

**TO RE-ENERGIZE TRANSFER SWITCH**

- REMOVE APPLICABLE PADLOCKS AND MOVE SERVICE DISCONNECT SWITCH BACK TO THE ENERGIZED POSITION.
- REPLACE ENCLOSURE DOOR KEY IF FUTURE ACCESS REQUIRED.

DRAWINGS AND/OR OTHER TECHNICAL INFORMATION SUPPLIED BY THOMSON POWER SYSTEMS AS A PART OF A SALE OF EQUIPMENT ARE FOR THE PURCHASER'S USE SOLELY IN CONJUNCTION WITH THAT EQUIPMENT, UNLESS SPECIFICALLY AGREED TO OTHERWISE AS A PART OF THE TERMS OF SALE.

CUSTOMER THOMSON POWER SYSTEMS			
CUSTOMER ORDER No. C-XXXXXX	WORK ORDER No. W-XXXXXX		
DRAWN BY NS	AUTH BY OG	DATE 22-11-22	REV 1
DRAWING/FILE No. MCS870M424	SHEET 10A		

APPROVED FOR CONSTRUCTION  
 MASTER COPY  REFERENCE COPY OF \_\_\_\_\_  
 MULTIPLE UNIT WORK ORDER  
 RELEASED FOR INFORMATION  
 AUTH. BY: \_\_\_\_\_ DATE: \_\_\_\_\_

CROSS REFERENCE LEGEND  
 50C-C-1  
 GRID COORDINATE  
 SHEET No. \_\_\_\_\_

DRAWING No.	REFERENCE DRAWINGS	No.	REVISIONS	BY	OG	DATE
1	UPDATED Z-BUS			NS	OG	23-07-04



**AUTOMATIC TRANSFER SWITCH MODEL TS 870**  
**PHYSICAL LAYOUT & INSTALLATION DETAILS**  
 400A, 2P/3P, NEMA 1/2/12/3R SD, MCS ATS, SE

FOR REVIEW ONLY